

UNIT, DIRECT SUPPORT, AND GENERAL SUPPORT MAINTENANCE  
REPAIR PARTS AND SPECIAL TOOLS LIST  
TRUCK, 5-TON, 6X6, M809 SERIES TRUCKS (DIESEL)

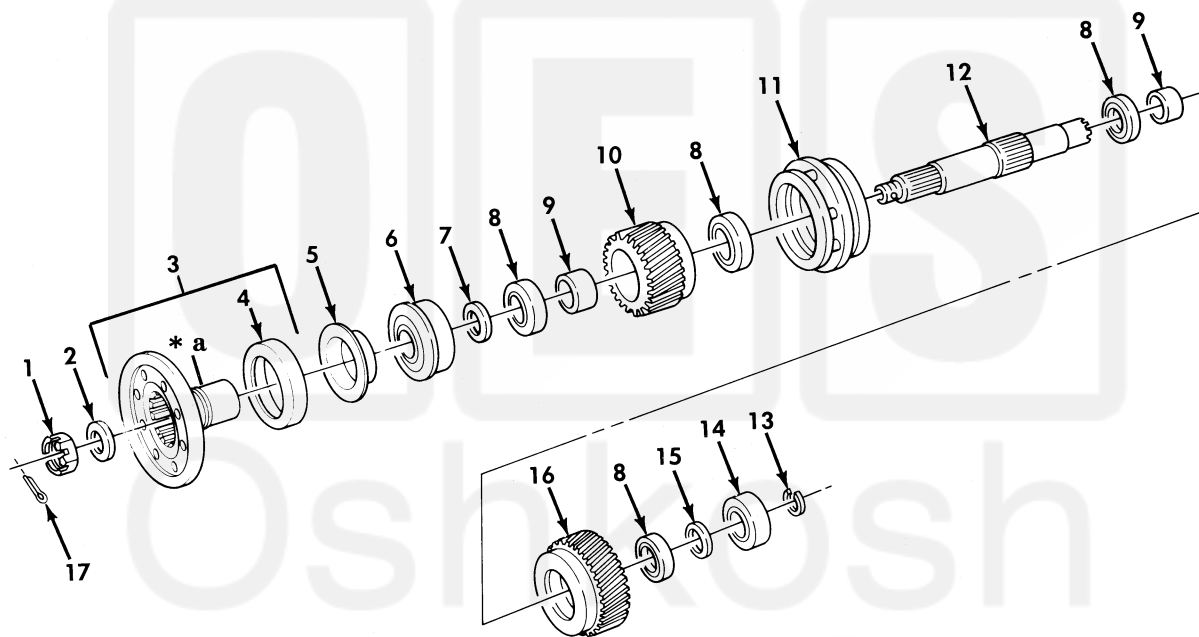

**\* a PART OF ITEM 3**

*Figure 142. Transfer Clutch and Input Shaft.*

(1) ITEM NO	(2) SMR CODE	(3) NSN	(4) CAGEC	(5) PART NUMBER	(6) DESCRIPTION AND USABLE ON CODE (UOC)	(7) QTY
GROUP 0801 POWER TRANSFER AND FINAL DRIVE ASSEMBLIES						
FIG. 142 TRANSFER CLUTCH AND INPUT SHAFT						
1	PAFZZ	5310-00-492-9631	76040	A143813	NUT, PLAIN, SLOTTED, H.....	1
2	PAFZZ	5310-00-188-4199	76894	15235	WASHER, FLAT.....	1
3	PAFZZ	2520-00-734-6802	78500	5WCS32-37A	FLANGE, COMPANION, VE.....	1
4	PAFZZ	2520-00-563-8309	78500	2847Z312	.DEFLECTOR, DIRT AND.....	1
5	PAFZZ	4910-01-343-4621	80201	99293	REPAIR KIT, SLEEVE.....	1
6	PAHZZ	3110-00-555-5337	19207	7376365	BEARING, BALL, ANNULA.....	1
7	PAHZZ	5365-00-033-6014	19207	7375253	SPACER, RING.....	1
8	PAHZZ	3110-00-555-5429	08162	1211S	BEARING, BALL, ANNULA.....	4
9	PAHZZ	5365-00-737-5252	78500	1844Z364	SPACER, SLEEVE.....	2
10	PAHZZ	3020-00-953-9909	19207	7748587	GEAR, HELICAL.....	1
11	PAHZZ	3020-00-734-6755	19207	7346755	COLLAR TRANSFER CAS.....	1
12	PAHZZ	3040-00-953-9907	19207	7748585	SHAFT, SHOULDERED.....	1
13	PAHZZ	5325-00-737-5285	19207	7375285	RING, RETAINING.....	1
14	PAHZZ	3110-00-155-6742	02413	7310	BEARING, BALL, ANNULA.....	1
15	PAHZZ	5310-00-033-6015	19207	7375254	WASHER, FLAT.....	1
16	PAHZZ	3020-00-064-6372	19207	7748588	GEAR, HELICAL.....	1
17	PAFZZ	5315-00-059-0184	96906	MS24665-361	PIN, COTTER.....	1

END OF FIGURE

